

MEETINGS

A NEW PERSPECTIVE



SPACE TO EXPAND IDEAS

Strategically located at Porte Maillot, across from the Paris Convention Centre and close to La Défense, the hotel sits just steps from the Arc de Triomphe and the Champs-Élysées. The sophisticated 1,025 guestrooms include 369 new Executive guestrooms and 23 suites.

L'Orénoc restaurant and the newly renovated Jazz Club Etoile which features live music every night, punctuate the hotel as excellent options for rounding out a memorable Parisian evening.

HOTEL SERVICES

For vitalization or relaxation, Le Méridien Etoile proposes you its in-room spa services that allow you to experience a true spa treatment without leaving the comfort of your room. A fitness centre is also located just across the street.

GUESTROOM AMENITIES

Each guestroom and suite features satellite flat screen TV, movies on demand, high-speed internet access, international direct dialing, hair dryer, mini-bar, pleasant bathroom and in-room safe. Room service, concierge, reception and a business centre are at disposal 24 hours a day.

GUESTROOMS

1,025 rooms and suites:

278 Classic Rooms
378 Deluxe Rooms
369 Executive Rooms

including:

11 Junior Suites
08 Senior Suites
02 Corner Suites
01 Deluxe Suite
01 Presidential Suite

Explore our new forward-thinking Executive rooms: contemporary design, Le Méridien bed signature, multi-task LCD screen.

CUISINE

Flavours, colours and aromas combine. Le Méridien cuisine awaits your exploration.

L'Orénoc (lunch and dinner)
Jazz Club Lounge (all-day dining)
Jazz Club Etoile (bar + live music)

CONFERENCE CENTRE

The conference centre - 26,910 sq. ft/2,500 sq. meters - is composed of 25 multi-purpose modular rooms for events up to 1,200 guests. L'Espace des Philosophes offers 9 deluxe and high-tech meeting rooms for 10 to 25 guests. State-of-the-art audio and video equipment, high speed Internet and WiFi access. New: La Terrasse Eiffel, an open space overlooking Paris, offers a creative and stimulating environment for meetings and events. The Jazz Club Etoile can also be privatised for events up to 240 guests.

ROOM KEYS THAT OPEN MORE THAN DOORS. THEY CAN OPEN MINDS. CUISINE THAT EXPLORES NEW PAIRINGS WHILE EXPANDING YOUR PALATE. A HOTEL THAT CAN OFFER YOU A NEW PERSPECTIVE ON YOUR DESTINATION, AND ON THE WAY THAT YOU SEE THE THINGS AROUND YOU.

WE INVITE YOU TO DISCOVERY. WELCOME TO LE MERIDIEN ETOILE.

Le **MERIDIEN**

LE MERIDIEN ETOILE
81 BOULEVARD GOUVION SAINT-CYR,
75848 PARIS CEDEX 17 FRANCE

T +33 1 40 68 34 34
F +33 1 40 68 31 31

lemeridien.com/etoile

N 48° 52' E 2° 17'

Espace Longchamp

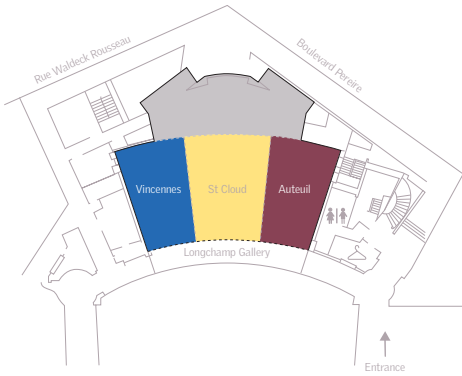

Espace des Philosophes



Espace des Impressionnistes

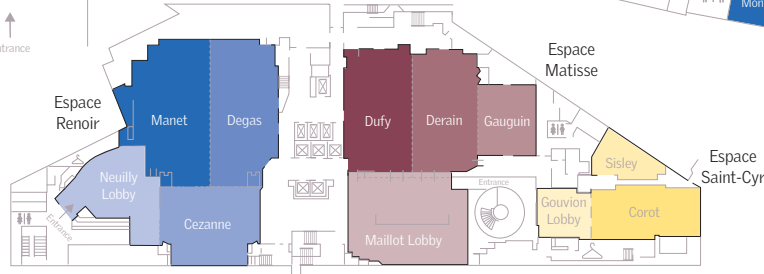

Espace Matisse

Espace Saint-Cyr



FUNCTION ROOMS CAPACITY CHART

FUNCTION ROOM	SQ FT	SQ M	LENGTH FT x WIDTH FT	LENGTH M x WIDTH M	HEIGHT FT	HEIGHT M	THEATRE	CLASSROOM	U-SHAPE	COCKTAIL	BANQUET	CABARET
■ Espace Renoir	9,149	850	108,26 X 72,17	33 X 22	10,49/11,81	3,20/3,60	1000	450	/	1200	700	480
■ Manet	2,906	270	72,17 X 42,65	22 X 13	10,49/11,81	3,20/3,60	300	150	80	300	210	136
■ Degas	2,799	260	72,17 X 39,37	22 X 12	10,49/11,81	3,20/3,60	320	130	70	250	190	120
■ Cézanne	2,045	190	36,08 X 55,77	11 X 17	10,49/11,81	3,20/3,60	/	/	/	250	190	/
■ Espace Matisse	6,135	570	65,61 X 108,3	20 X 33	11,48/12,95	3,50/3,95	750	250	/	1000	520	320
■ Dufy	2,368	220	65,61 X 36,08	20 X 11	11,48/12,95	3,50/3,95	280	130	70	250	180	120
■ Derain	2,368	220	65,61 X 39,37	20 X 12	11,48/12,95	3,50/3,95	280	130	70	250	180	120
■ Gauguin	1,076	100	36,08 X 32,80	11 X 10	11,48/12,95	3,50/3,95	80	60	40	100	80	48
■ Sisley	753	70	32,8 X 22,96	10 X 7	8,03	2,45	40	/	20	30	40	32
■ Corot	1,507	140	57,41 X 26,24	17,5 X 8	9,18/9,84	2,80/3	140	60	40	120	100	64
■ Espace Longchamp	4,844	450	65,51 X 73,81	20 X 22,5	8,53/9,84	2,60/3	/	/	/	450	410	/
■ Vincennes	969	90	40,01 X 23,62	12,5 X 7,2	8,53/9,18	2,60/2,80	90	40	30	80	80	48
■ St Cloud	1,130	105	40,01 X 31,16	12,5 X 9,5	8,53/9,18	2,60/2,80	120	50	30	80	80	56
■ Auteuil	969	90	40,01 X 23,62	12,5 X 7,2	8,53/9,18	2,60/2,80	90	40	30	80	80	48
■ Montesquieu	517	48	27,88 X 18,04	8,5 X 5,5	7,21/8,20	2,20/2,50	/	/	16	/	/	/
■ Pascal	721	67	34,44 X 20,34	10,5 X 6,2	7,21/8,20	2,20/2,50	/	/	25	/	/	/
■ Descartes	646	60	34,44 X 14,76	10,5 X 4,5	7,21/8,20	2,20/2,50	/	/	23	/	/	/
■ Diderot	678	63	34,44 X 19,02	10,05 X 5,8	7,21/8,20	2,20/2,50	/	/	25	/	/	/
■ Montaigne	355,21	33	22,63 X 15,41	6,9 X 4,7	7,21/8,20	2,20/2,50	/	/	12	/	/	/
■ Tocqueville	560	52	29,52 X 19,68	9 X 6	7,21/8,20	2,20/2,50	/	/	19	/	/	/
■ Mirabeau	560	52	29,52 X 19,68	9 X 6	7,21/8,20	2,20/2,50	/	/	18	/	/	/
■ Rousseau	301	28	21,32 X 14,10	6,5 X 4,3	7,21/8,20	2,20/2,50	/	/	10	/	/	/
■ Voltaire	301	28	21,32 X 14,10	6,5 X 4,3	7,21/8,20	2,20/2,50	/	/	10	/	/	/
■ Terrasse Eiffel	1,111	100			7,44	2,27	30	17	/	50	/	/

Banquet (lunch/dinner) style: 10 pax/table - Cabaret style: 8 pax/table

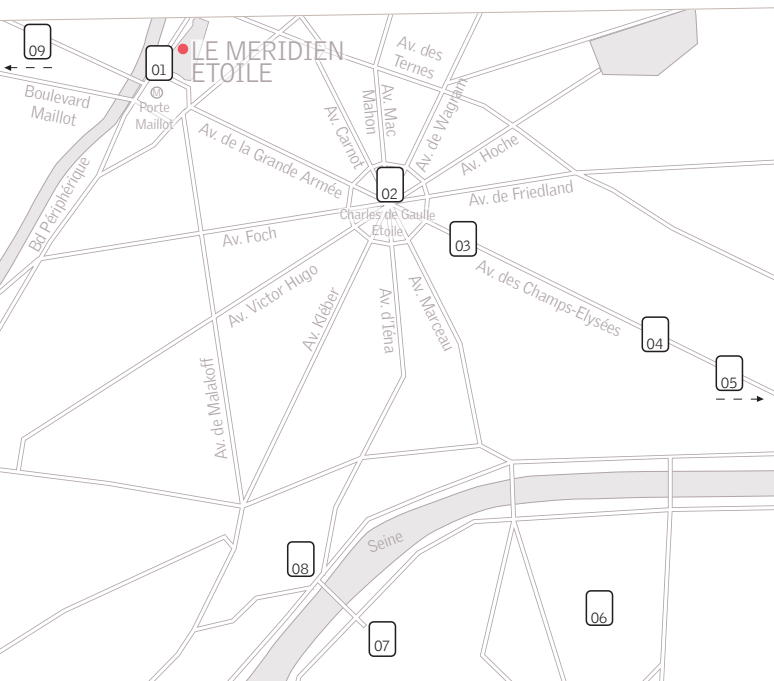

EXPLORATION AWAITS

- 01 Paris Convention Centre
- 02 Arc de Triomphe
- 03 Champs-Élysées avenue
- 04 Place de la Concorde
- 05 Louvre Museum
- 06 Quai Branly Museum
- 07 Eiffel Tower
- 08 Palais de Tokyo
- 09 La Défense

ACCESS

Charles de Gaulle International Airport 27 km / 40 minutes
 Air France Shuttle just across the hotel
 Orly Airport 25 km / 40 minutes